

B.E.G. LUXOMAT® PD9-1C(-GH)-FC

Installation and Operating Instruction for B.E.G.-Occupancy detectors PD9-1C(-GH)-FC

1. Mounting preparations

Work on the 230V mains supply may only be carried out by qualified professionals or by instructed persons under the direction and supervision of qualified skilled electrical personnel in accordance with electrotechnical regulations.

Disconnect supply before installing!

When in Master/Slave mode of operation, the Master-appliance must always be installed at the location where there is least daylight.

2a. Installation

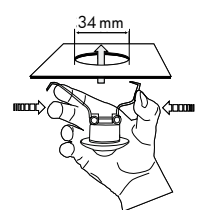

The detector has been designed and developed specifically for installation in suspended ceilings.

A circular opening of diameter min. 34 mm must be produced in the ceiling.

Having connected the cables in accordance with the regulations, connect the power supply via the RJ11 plug. Therefore, open the power supply with the help of the screws and close it afterwards. After that, put the power supply through the opening in the ceiling and mount the sensor onto the ceiling according to figure.

2b. Connecting terminals

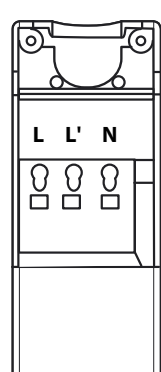

2c. Self test cycle

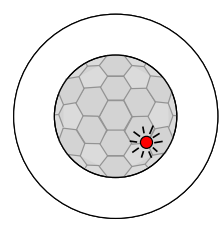

The LUXOMAT® PD9-1C(-GH) enters an initial 60-second self-test cycle, when the supply is first connected. The occupancy detector is ready for operation.

3. Exclude sources of interference

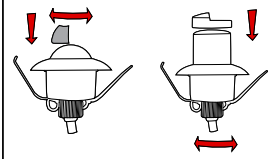

In case the sensing area of the LUXOMAT® PD9-1C(-GH)-FC is too large or areas are being covered that should not be monitored, the range can be reduced or limited through use of the enclosed masking clips.

4. Putting into operation / Settings

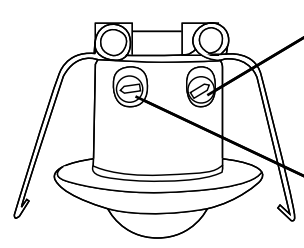

Follow-up time for light control
The time can be set infinitely variably at between 30 seconds and 30 minutes.
Symbol \square : Impulse < 1 sec.
Symbol TEST: Test mode (Every movement switches on the light for a period of 1 second, switching it off for a period of 2 seconds after that regardless of the level of brightness)



Twilight-switch for light control
The switch-on value for the light can be set at between 10 and 2000 Lux. Using the rotary control, the luminance set points can be set as desired.
Symbol ☾ : Night-time operation
Symbol ☀ : Daytime/Night-time operation

5. Dimensions

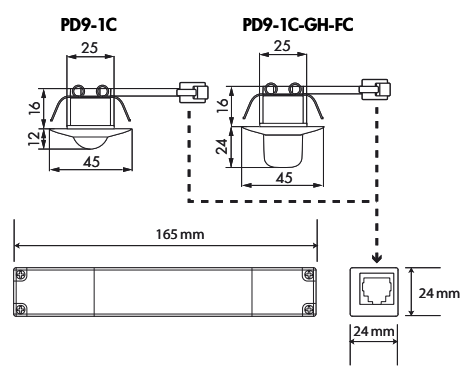

6. Article / Part-Nr. / Accessory

Type	RAL9010	RAL9006
PD9-1C-FC	92902	92903
PD9-1C-GH-FC	92934	92935

Accessory:

Wire basket BSK		92199
Covering for PD9	white	92238
Covering for PD9	silver	92237
Covering for PD9	anthracite	92235
Blind GH	white	33207

7. Technical data

Connection of sensor and power supply by means of telephone plug R J11

Power supply: 230V~ +6%/-10%
Power consumption: < 1W
Ambient temperature: -25°C - +50°C
Degree of protection/class: IP20 / II / CE
Settings: Settings made manually using potentiometer
 10 - 2000 Lux
 circular 360°

Light values:
Area of coverage:
Range Ø H 2.50 m / T = 18°C:
 PD9-1C-FC seated 2.50 m / tangential 10 m / radial 6 m max. Ø 5.40 m
 PD9-1C-GH-FC max. Ø 5.40 m

Recommended height for mounting
 PD9-1C-FC 2 - 3 m
 PD9-1C-GH-FC 5 - 10 m

Light measurement: daylight and artificial light
One channel to switch the lighting
Type of contact: NOC/with pretravel tungsten contact
Contact load: 1000 W, cos(φ)=1 / 500 W, cos(φ)=0,5
Time-settings: 30 sec. - 30 min. / Test

Dimensions H x Ø [mm]
 PD9-1C-FC Ø 45 x H 12 mm
 PD9-1C-GH-FC Ø 45 x H 40 mm
 Power supply L 165 x W 24 x H 24 mm

8. Trouble shooting

- Lamp does not light up**
Lamp may be defect: Replace lamps
No mains connection/power: Check connection and mains fuse by qualified electrician
Incorrect setting of CDS twilight threshold: Correct setting of CDS threshold
Lens of sensor unit obstructed by dirt or other objects: Clean lens, remove objects
- Lamp turns ON too late or detection range too small**
LUXOMAT® PD9-1C-GH-FC is mounted too high: See table of mounting heights. Correct mounting if required.
- Lamp stays ON continuously**
Continuous thermal activity detected i.e fan, central heating ducts, animals within detection area: Remove heatsource. Check proper function of LUXOMAT® PD9-1C-GH-FC by covering the fresnel lens. After expiry of delay timer, has to turn OFF lighting.
LUXOMAT® PD9-1C-GH-FC connected in parallel to a manual override switch: Connect switch correctly
- Unintended switching of light**
Movement of heat source within detection area: Check on presence of animals, fans or heaters

9. Range of Coverage

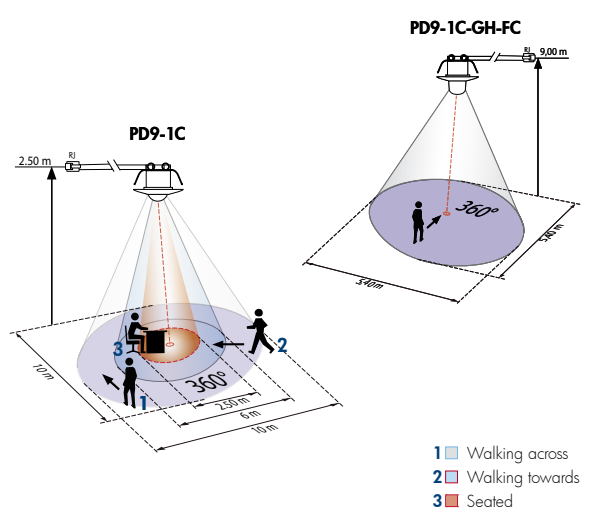

- 1 Walking across
- 2 Walking towards
- 3 Seated

10. Wiring diagram

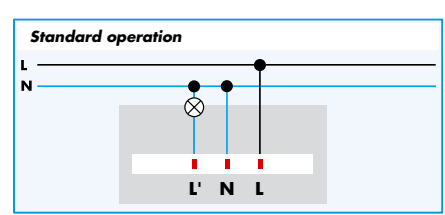

Declaration of Conformity: The product complies with the low voltage recommendation 2006/95/EC and the EMV recommendation 2004/108/EC.